

TS-x73A Series

AMD Ryzen V1500B 4C/8T 2.2 GHz 2.5GbE NAS
 supports M.2 NVMe SSD and dual PCIe for 10GbE



QTS / QuTS hero



NAS for professionals and SMBs.

The new TS-x73A AMD Ryzen 4/6/8-bay desktop NAS

- 2020/06 Launched the industry-first **AMD V1500B Ryzen 8/12/16-bay TS-x73AU** rackmount NAS series.
- 2020/11 Launched the **9-bay TS-h973AX** desktop NAS.
- 2021/02 Introducing the same powerful V1500B into **4-bay TS-473A, 6-bay TS-673A and 8-bay TS-873A** desktop NAS.

- TVS-x63 series
- TS-x63XU series

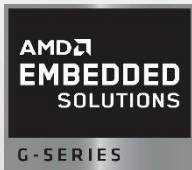

- TS-x73 series
- TS-x73U series

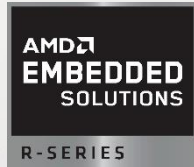

- **TS-x73A series**
- TS-h973AX
- TS-x73AU series



TS-h2490FU

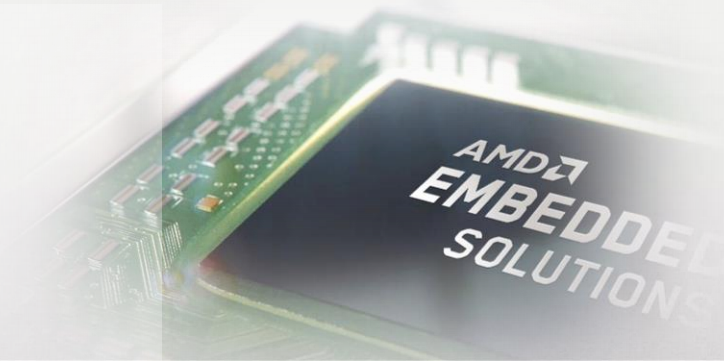
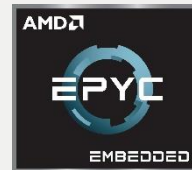

The new TS-x73A Ryzen NAS with many upgrades over previous generation TS-x73

QTS / QuTS ^{hero}

Dual NAS OS support

Default is QTS, switchable to ZFS QuTS hero enterprise OS during setup



AMD Ryzen V1500B 4C / 8T 2.2GHz SoC

Next-gen AMD Ryzen embedded processor

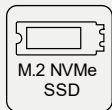

M.2 PCIe NVMe SSD

Dual M.2 2280 NVMe SSD slots for performance



2.5GbE high-speed network

2 x 2.5GbE for fast data transfer speed

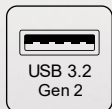

USB 3.2 Gen 2 10Gbps

3 x USB-A 10Gbps for quick backup with SSD or enclosure



AMD long-term supported Zen core embedded SoC

The low-power V1000 series V1500B 4C 8T 2.2 GHz

TS-x73A

Processor	V1500B
Cores	4
Threads	8
Base frequency	2.2 GHz
Turbo frequency	---
L2 cache	2MB
L3 cache	4 MB
Memory	DDR4
TDP	12 to 25 W
CPU family	Zen



TS-473A front view

LED indicators:
System status, LAN,
HDD, M.2 SSDs

**4 x 3.5"/2.5" SATA
6Gb/s HDD/SSD bays**



**Lockable drive
Trays**
(2 keys are
included)



Power button

**USB 3.2 Gen 2 Type-A
10Gbps port &
One-Touch Copy button**

TS-673A / TS-873A front view

Lockable drive Trays (2 keys are included)



LED indicators:
System status, LAN,
HDD, M.2 SSDs

6 or 8 x 3.5"/2.5"
SATA 6Gb/s
HDD/SSD bays



TS-673A



TS-873A

Power button

USB 3.2 Gen 2
Type-A 10Gbps
port & One-Touch
Copy button

Easy installation of disks and lockable trays

Tool-less
installation of
3.5-inch HDDs

3.5-inch HDD

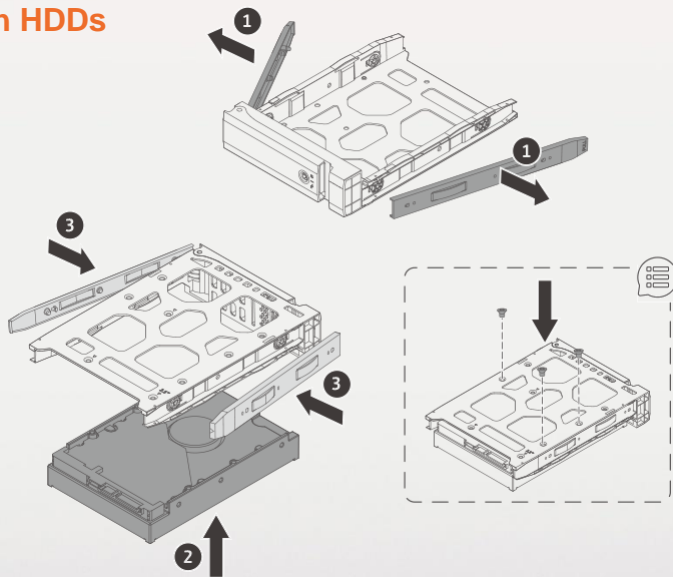

2.5-inch SSD / HDD

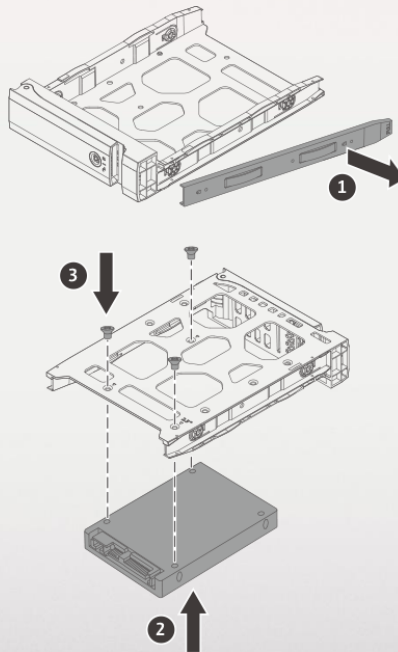

Note: Use screws if transporting the NAS
or if using some HDDs that vibrate more.

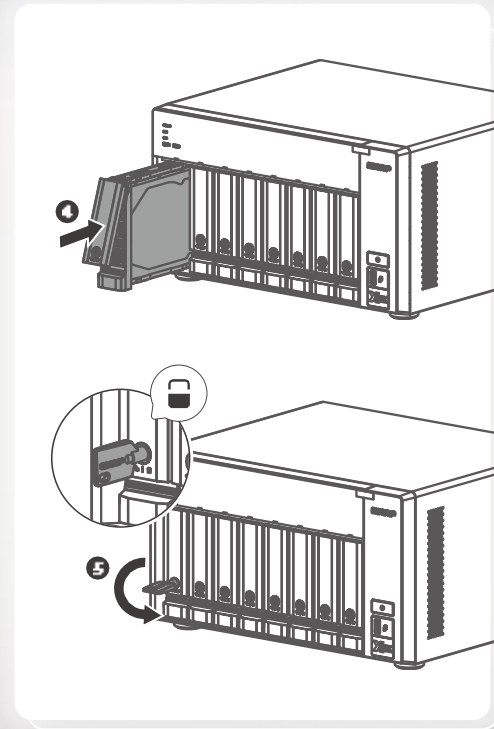

TS-473A rear view

**2 x PCIe Gen3 x4
half-height slots**

(10GbE/5GbE/2.5GbE, QM2
SSD, Fibre Channel, SATA,
SAS expansion cards)

2 x 2.5GbE LAN ports

(2.5G/1G/100M RJ45)

**2 x USB 3.2 Gen 2
10Gbps Type-A port**

**1 x USB 3.2 Gen 1
5Gbps Type-C port**

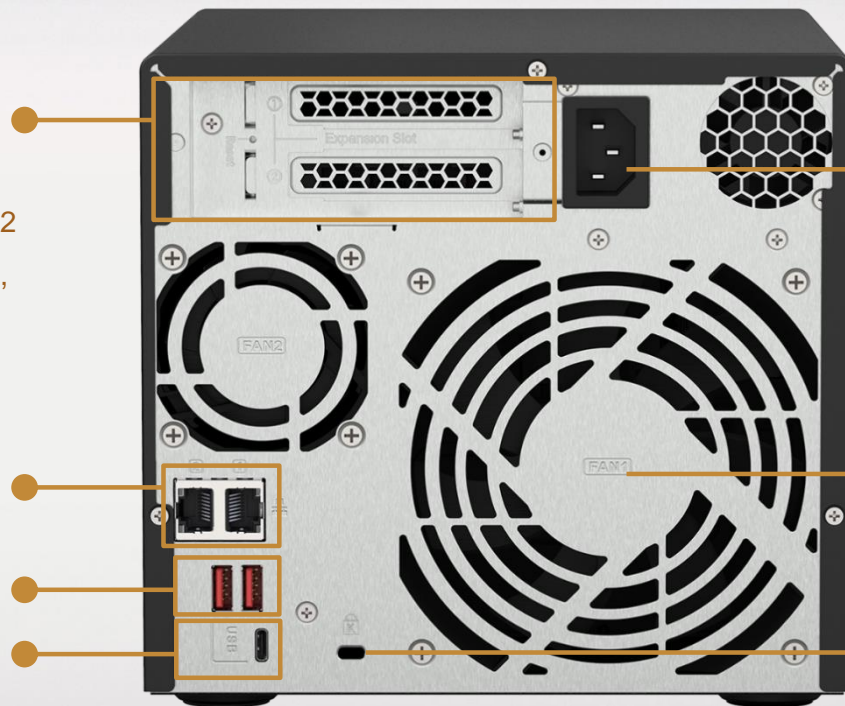

250W 100-240VAC PSU

**6CM CPU-side fan +
12CM disk-side fan**

**Kensington
security slot**

TS-673A / TS-873A rear view

**2 x PCIe Gen3 x4
full-height slots**

(10GbE/5GbE/2.5GbE,
QM2 SSD, Fibre Channel, SATA,
SAS expansion cards)

2 x 2.5GbE LAN ports

(2.5G/1G/100M RJ45)

**2 x USB 3.2 Gen 2
10Gbps Type-A port**

**1 x USB 3.2 Gen 1
5Gbps Type-C port**

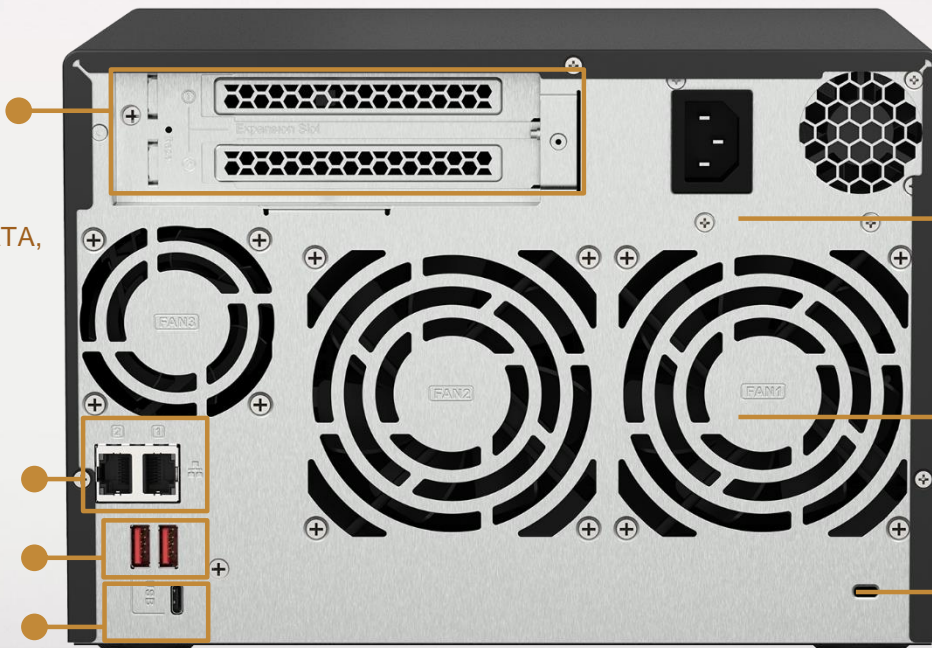

TS-673A

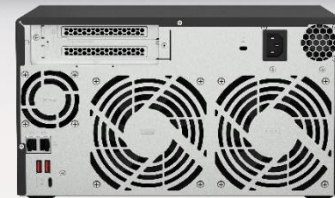

TS-873A

250W 100-240VAC PSU

- ◆ TS-673A: 6CM CPU-side fan + 2 x 9CM disk-side fan
- ◆ TS-873A: 6CM CPU-side fan + 2 x 12CM disk-side fan

**Kensington
security slot**

2 x M.2 NVMe PCIe SSD slots supporting SSD cache or Qtier auto tiering

2 x M.2 2280 PCIe Gen3 x1 NVMe SSD slots for SSD cache or Qtier auto tiering performance enhancement.

- **Improve random data access speeds with an SSD cache**
SSD caches accelerate IOPS performance and reduce latency for storage volumes. They are perfect for IOPS-demanding applications (including databases and virtualization) and can significantly improve overall workflows.
- **Maximize the value of SSDs with Qtier Technology**
Qtier™ Technology empowers TS-x73A with auto tiering that helps continuously optimize storage efficiency by automatically moving data between M.2 SSDs, 2.5-inch SSDs, and high-capacity HDDs based on the data's access frequency. Qtier™ 2.0 features IO-awareness that empowers SSD-tiered storage with a cache-like reserved space to handle burst I/O in real time, greatly maximizing the advantages of SSDs.

Note: Qtier is only supported in the QTS OS, not in the QuTS hero OS.

1. Remove screws and cover

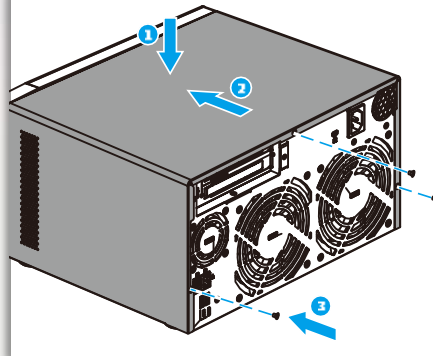

2. Install M.2 NVMe SSD

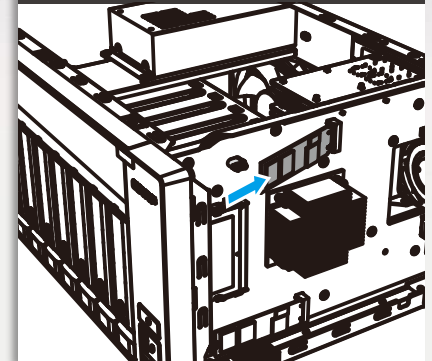

3. Tool-less installation

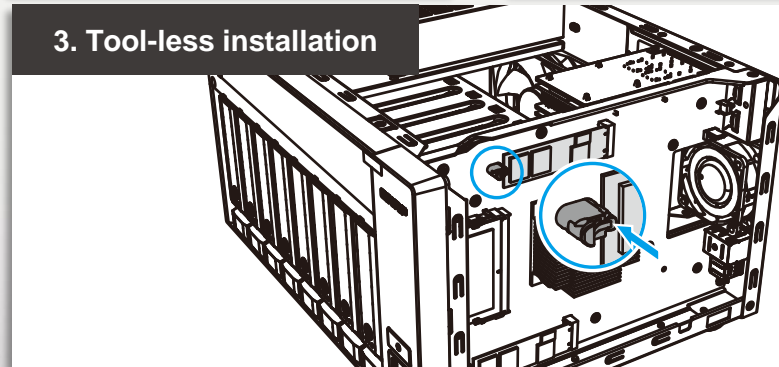

M.2 NVMe SSD and Qtier auto-tiering for speed and capacity

Qtier engine

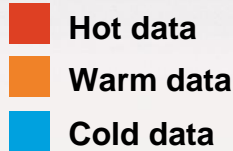

- Automatically moves data between different tiers
- SSD tier capacity is not limited by RAM size

01

Before tiering

Frequently accessed data is not optimized.



02

Start tiering



03

After tiering

Data is optimized

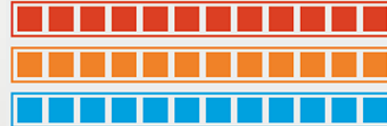

04

Changes in data access pattern



Note: Qtier is only supported in the QTS OS, not in the QuTS hero OS.

Compartmentalized smart cooling

Enhanced design over the previous generation to separately detects the CPU and hard drive temperatures for dynamically adjusting separate fan speeds for an quieter operations in the office.

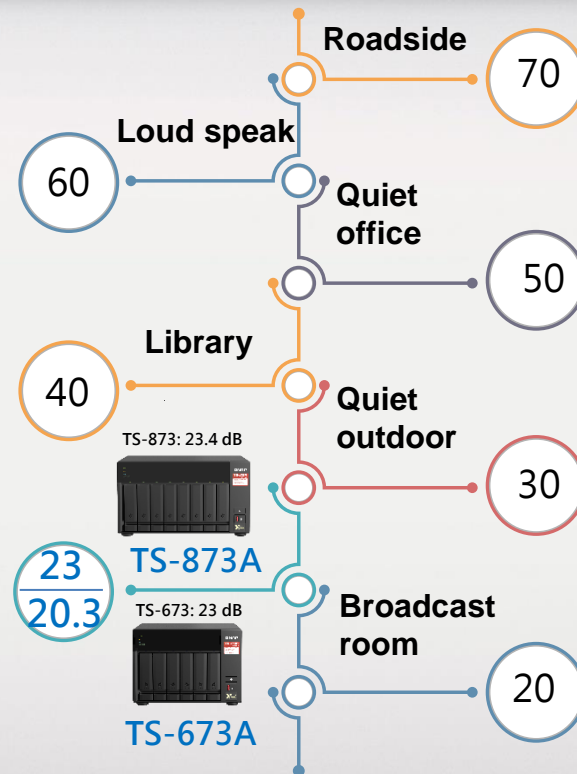
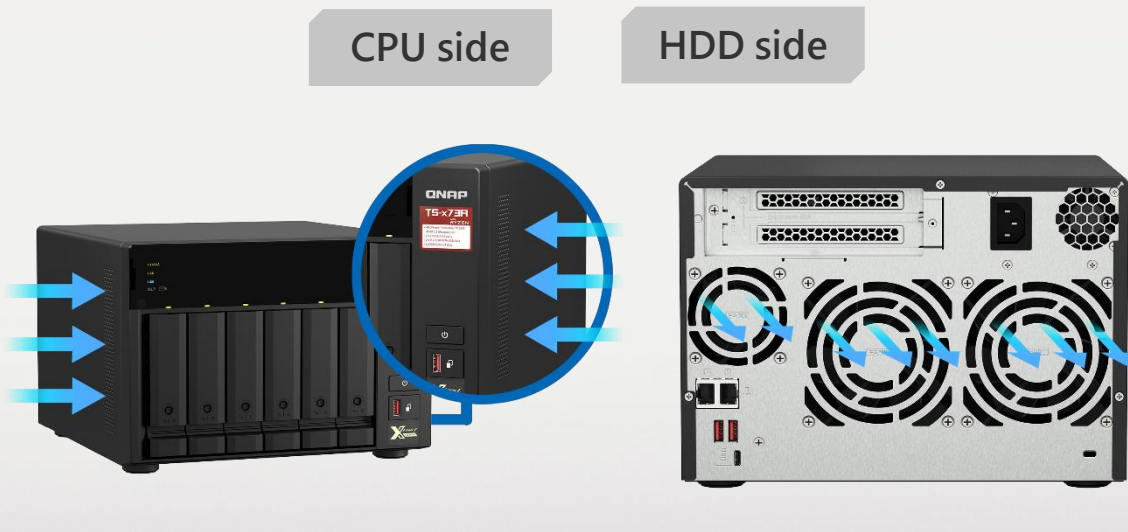

Sound pressure (dB)

Noise Test : Sound pressure is measured at the front bystander position with low fan speed.

Large pre-installed 8GB DDR4 RAM, upgradeable to max 64GB and also optional ECC RAM support

NAS Model Numbers:

TS-473A-8G

8 GB RAM (1 x 8 GB)

TS-673A-8G

8 GB RAM (1 x 8 GB)

TS-873A-8G

8 GB RAM (1 x 8 GB)

- 2 x DDR4 SO-DIMM RAM slots for a max of 64 GB (2 x 32 GB), dual-channel design and optional ECC RAM support.
- QNAP 8/16/32 GB RAM modules for easy upgrade and better multi-app or multi-user usage.

Note: Do not install ECC and Non-ECC RAM on the same NAS at the same time.

1. Remove the cover

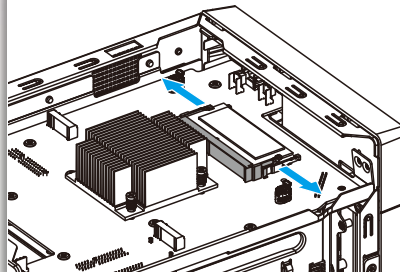

2. Remove the old RAM (optional)

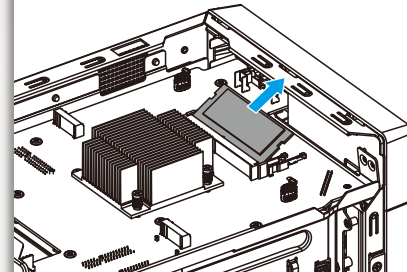

3. Install the new RAM

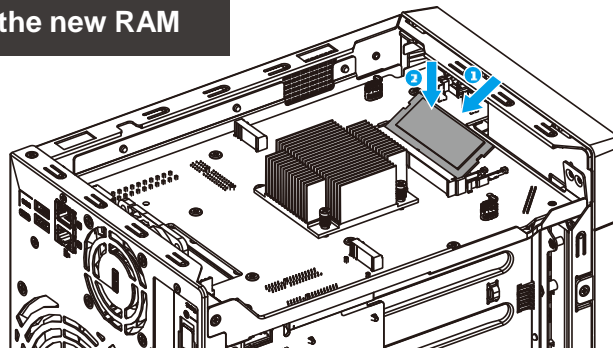

Built-in 2 x 2.5 GbE LAN ports, aggregated for maximum 5Gbps bandwidth



2.5GbE-supported motherboards, Wi-Fi 6 AP, switches, and LAN cards are now becoming popular

2.5GbE benefits



2.5X the speed



2.5GbE

1GbE → 2.5GbE

Huge leap in performance

Same cable



Use the same Cat.5e/
Cat.6/ Cat. 6A
LAN cables

2 x 2.5GbE LAN ports
(also 1GbE/100M)

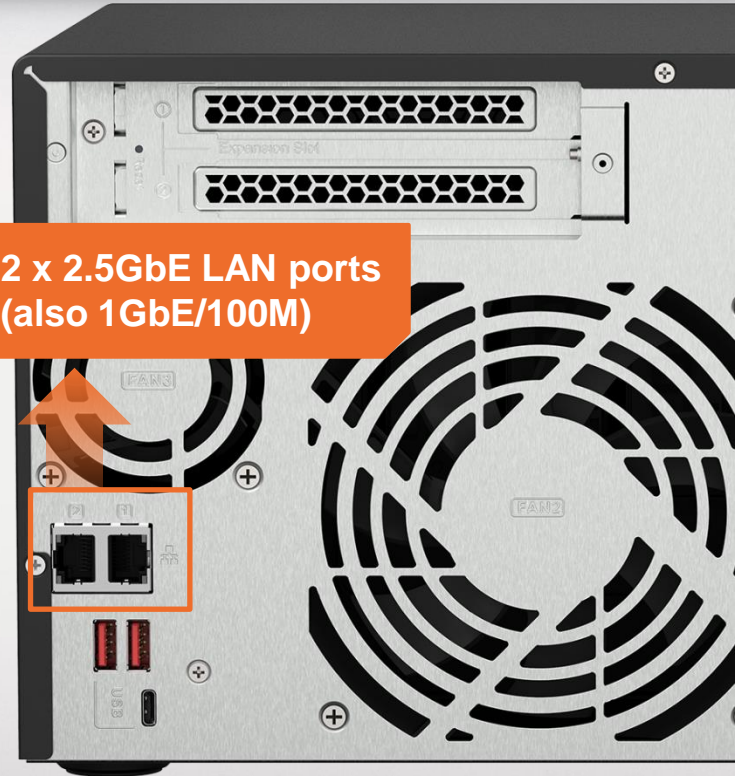

2 x PCIe slots for network, storage, and more

2 x PCIe Gen3 x4 expansion slots for various QNAP
PCIe cards for more value-added applications.

2 x PCIe Gen3 x4

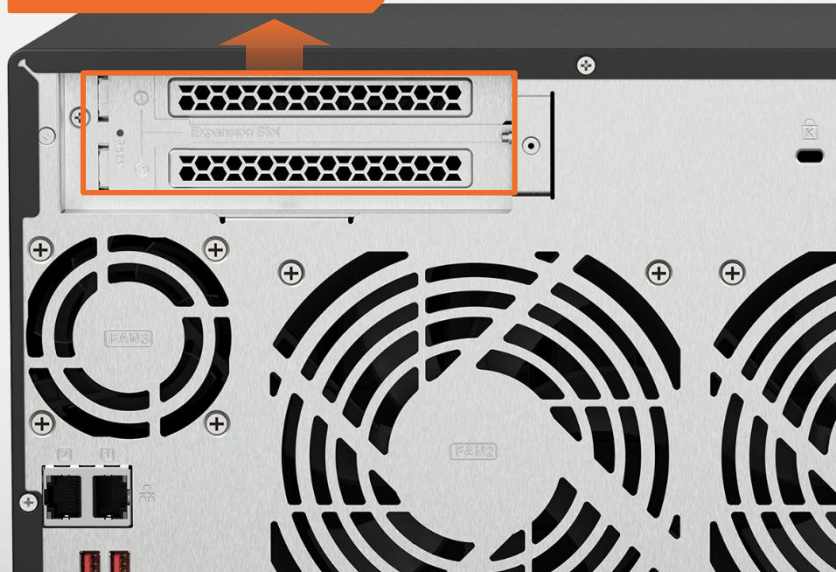

QXG 10GbE/5GbE/2.5GbE
network expansion cards

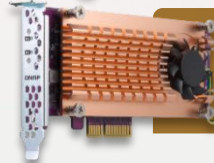

QM2 M.2 SSD cards



QXP SAS, SATA, USB
expansion cards

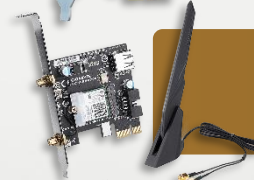

QXP Wi-Fi 6 & FC cards



QWA-AC2600 Wi-Fi AP card
Wi-Fi 5 2.4GHz/5GHz wireless AP

QM2 cards add support for SSD caching and 10GbE connectivity

- QM2 M.2 SSD PCIe cards allow adding 2 or 4 M.2 NVMe / SATA SSDs to TS-x73A. Enable SSD caching or create RAID 5 group with the two on-board M.2 NVMe SSDs using Qtier.
- Maximize the storage capacity and performance without occupying any 3.5" drive bays. Some QM2 models even combine M.2 SSD and 10GBASE-T connectivity into one solution.

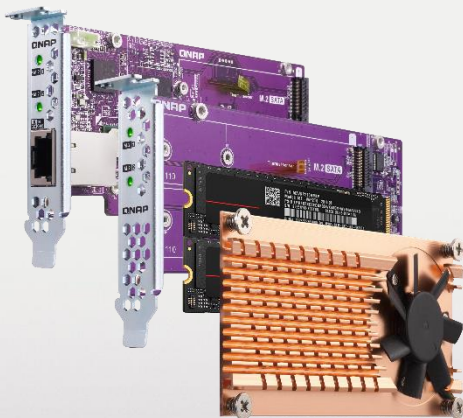

Active cooling module

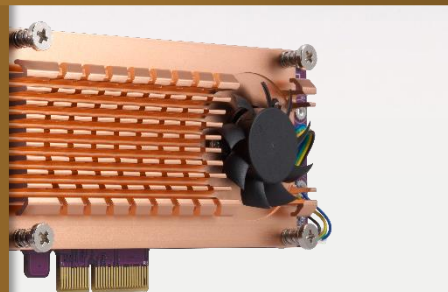

Thermal sensors allow real-time temperature monitoring and adjust fan rotation speed

Compatible with standard PCIe slots

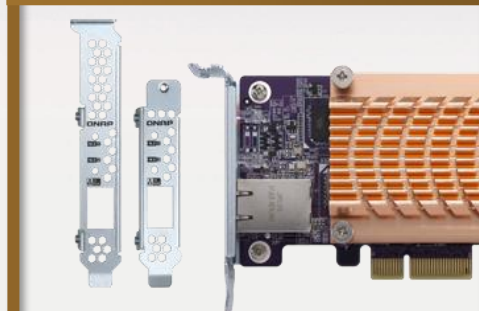

Low-profile PCIe card including full-height bracket

QM2 Series - Add more M.2 SSD slots to TS-x73A

2 x M.2 SSD
+ 10GbE or 2.5GbE



QM2-2S10G1TA
Bandwidth: PCIe Gen2 x4
2 x M.2 SATA 6Gbps
+ 1 x 10GBASE-T

QM2-2P10G1TA
Bandwidth: PCIe Gen2 x4
2 x M.2 PCIe Gen2 x2
+ 1 x 10GBASE-T

NEW

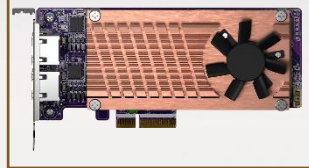

QM2-2P2G2T
Bandwidth: PCIe Gen3 x4
2 x M.2 PCIe Gen3 x2
+ 2 x 2.5GbE

2 x M.2 SSD

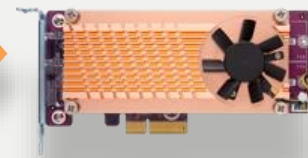

QM2-2P-344
Bandwidth: PCIe Gen3 x4
2 x M.2 PCIe Gen3 x4

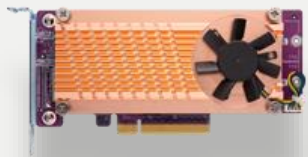

QM2-2P-384
Bandwidth: PCIe Gen3 x8
2 x M.2 PCIe Gen3 x4

4 x M.2 SSD



QM2-4P-342
Bandwidth: PCIe Gen3 x4
4 x M.2 PCIe Gen3 x2



QM2-4P-384
Bandwidth: PCIe Gen3 x8
4 x M.2 PCIe Gen3 x4

Budget-friendly unmanaged switches for multi-user environment



QSW-1105-5T (Unmanaged)

5 x 2.5GbE Multi-Gig RJ45

Fanless & metal housing



QSW-308-1C (Unmanaged)

QSW-1208-8C (Unmanaged)

8 x 10GbE Multi-Gig RJ45 / SFP+ combo
4 x 10GbE SFP+

1 x 10GbE Multi-Gig RJ45 / SFP+ combo
2 x 10GbE SFP+
8 x 1GbE RJ45

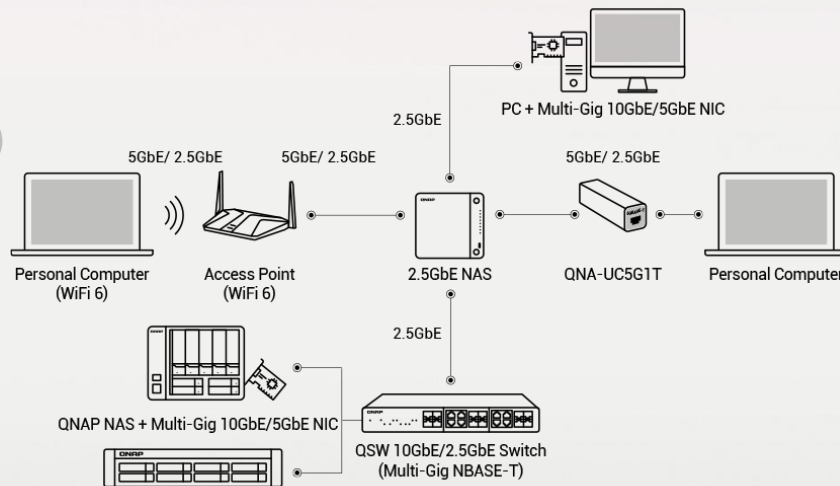

Layer-2 managed switches for multi-user environment and efficient deployment



QSW-M1208-8C (Managed)

8 x 10GbE Multi-Gig RJ45 / SFP+ combo
4 x 10GbE SFP+



QSW-M1204-4C (Managed)

4 x 10GbE Multi-Gig RJ45 / SFP+ combo
8 x 10GbE SFP+



QSW-M804-4C (Managed)

4 x 10GbE Multi-Gig RJ45 / SFP+ combo
4 x 10GbE SFP+



QSW-M408-4C (Managed)

4 x 10GbE Multi-Gig RJ45 / SFP+ combo
8 x 1GbE RJ45



QSW-M408-2C (Managed)

2 x 10GbE Multi-Gig RJ45 / SFP+ combo
2 x 10GbE SFP+
8 x 1GbE RJ45

Keep existing wiring for **2.5GbE**

	CAT 5e	CAT 6	CAT 6A
100M	✓	✓	✓
1G	✓	✓	✓
2.5G	✓	✓	✓
5G	✓	✓	✓
10G	X	✓ (55m)	✓

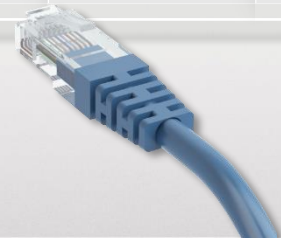

Optional 10GbE card for fast performance

2 x PCIe Gen3 x4 slots for many
10GBASE-T & 10GbE SFP+ cards

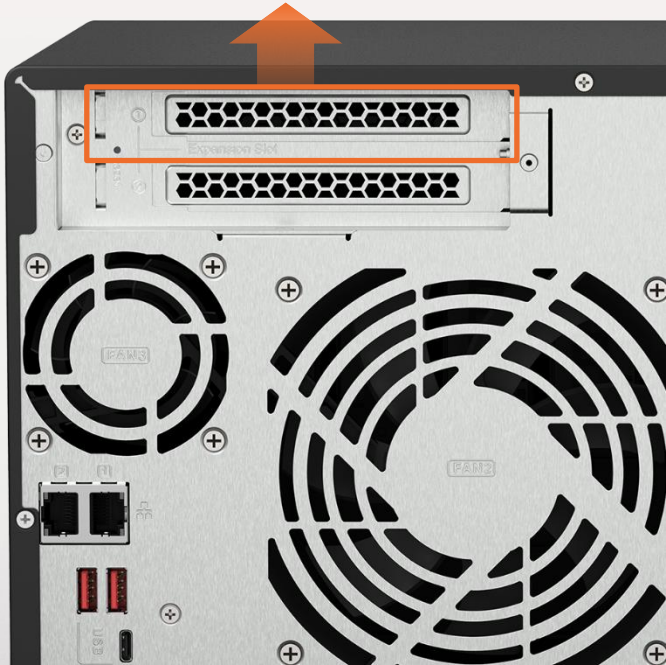

1 x 10GbE Windows file transfer

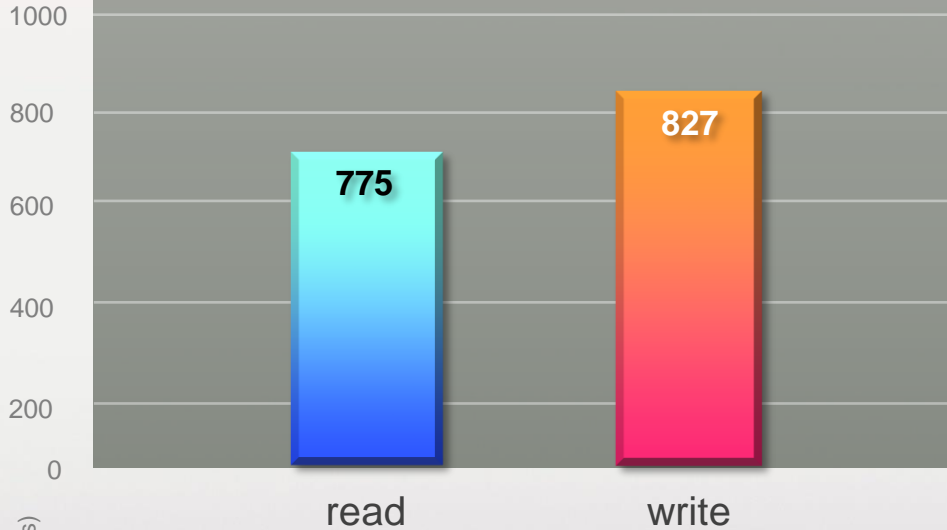

Test Environment:

NAS | TS-873A-8G, QTS 4.5.2, 8 x Samsung 850 Pro SSD, RAID 5, LAN-10G2T-X550
Client PC | Windows 10 Pro, Intel Core i7-6700 3.4 GHz, 64GB RAM, LAN-10G2T-X550

QNAP 16Gb Fibre Channel card for FC SAN



QXP-16G2FC
Dual-port 16Gbps
FC card with 16Gb FC
transceivers

Manage Fibre Channel
connection using **iSCSI &
Fibre Channel** app

- 16Gb FC transceiver
TRX-16GFCSFP-SR
16Gb/8Gb/4Gb



QNAP QXP-W6-AX200 Wi-Fi 6 card connects NAS wirelessly to a Wi-Fi 6 AX network



QNAP TS-873A NAS

+



Install the QXP-W6-AX200 PCIe Wi-Fi 6 card



QNAP QHora-301W Wi-Fi 6 10GbE SD-WAN router



Connect to Dropbox, OneDrive, Google Drive and more



Qfile

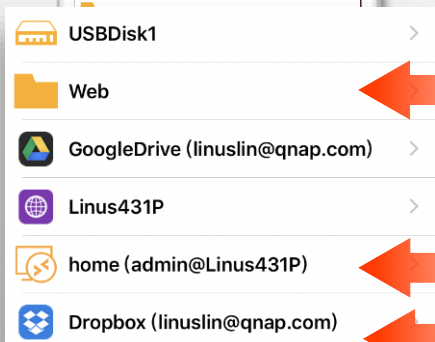
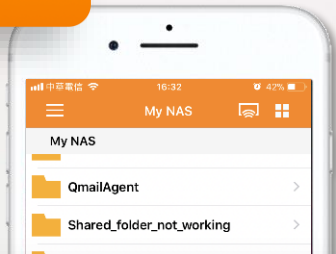

Local
NAS

Remote
NAS

Cloud
Storage



File Station

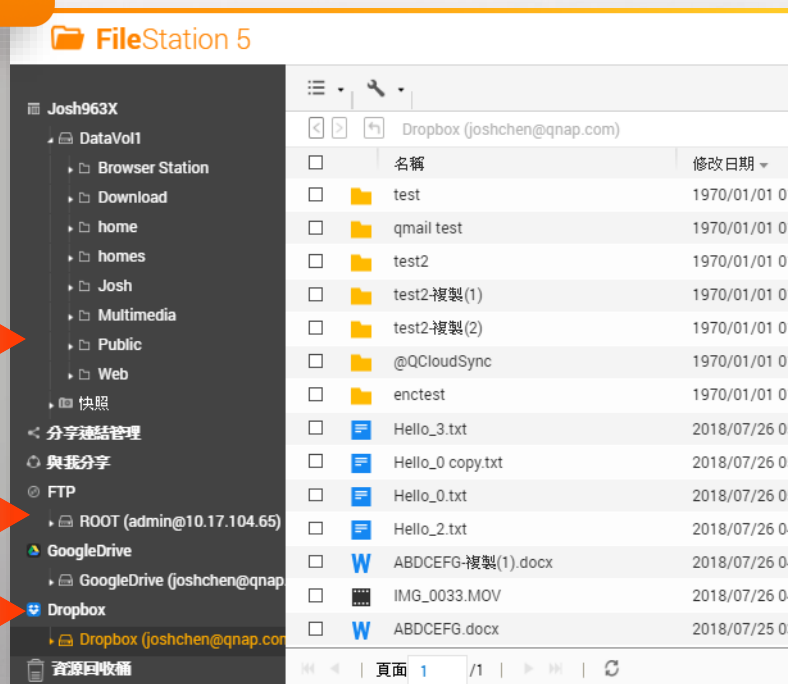

Easily make NAS your team collaboration portal with File Station



Edit with Office Online

View in Google Docs

Open with Google Chrome Extension

	Edit with Office Online	View in Google Docs	Open with Google Chrome Extension
Requirement	CloudLink needs to be enabled	CloudLink needs to be enabled	Use Chrome with extension "Office Editing for Docs, Sheets & Slides" to open
Supported formats	.docx, .pptx, .xlsx	.doc, .ppt, .xls .docx, .pptx, .xlsx	.doc, .ppt, .xls .docx, .pptx, .xlsx
Capabilities	<ul style="list-style-type: none"> File collaboration Auto save to NAS in real time 	<ul style="list-style-type: none"> Document preview Convert to Google docs for editing & saving in your Google Drive 	<ul style="list-style-type: none"> Document preview Convert to Google docs for editing & saving in your Google Drive

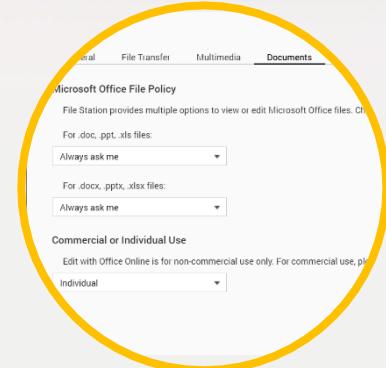

Select the default open action based on your preference in Settings > Documents.

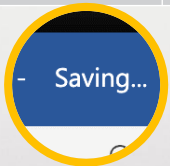

Save to NAS in real time

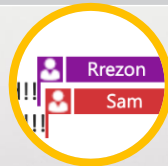

Multi-user online editing

Qsync 5.0 – Cross-device file sync for individuals and teams

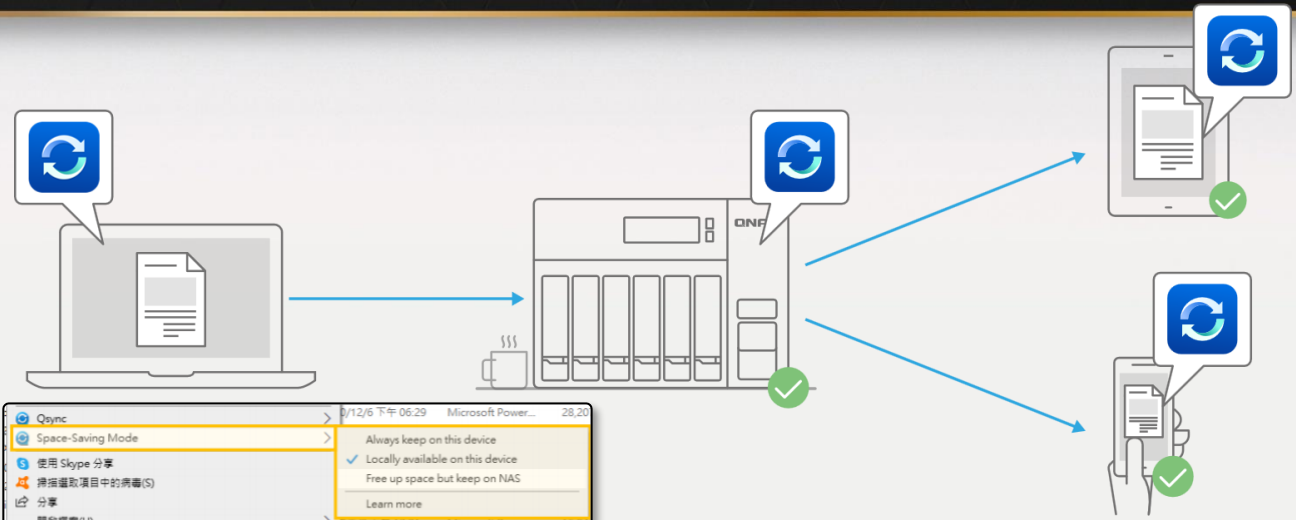

Windows & macOS
Space-Saving Mode!

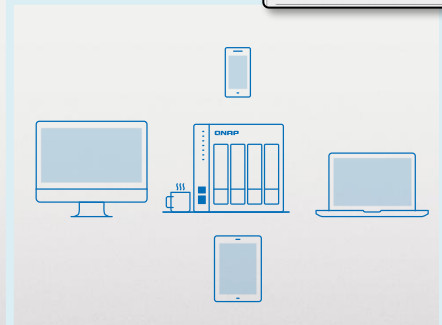

If you own many devices, any file changed on one device will be automatically synchronized with the others.

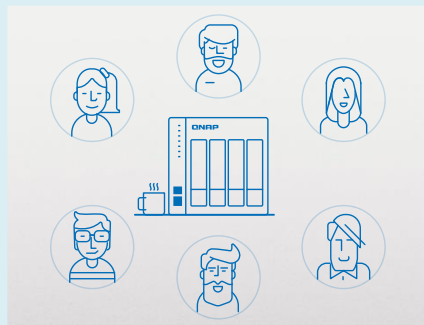

For team works, any file changed will be automatically distributed to your teams' devices, accelerating and streamlining your workflows.

Complete backup with 3-2-1 HBS 3



HBS 3 (Hybrid Backup Sync 3)

From local NAS
(via HBS 3)



Taipei



Taipei

File Station with QuDedup

Backup/Restore

TCP BBR

From remote NAS
(via File Station)



File Station with QuDedup



Access from
Cloud



Carry and use
(QuDedup Extract Tool)



Windows

Tokyo



MacOS

New York



ubuntu

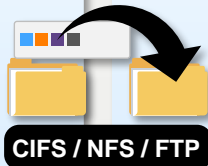

Beijing



CIFS / NFS / FTP



HybridMount provides two modes for file-based cloud storage gateway

	Network Drive Mount	File Cloud Gateway 
Setup Method	Mount cloud drives and file servers	Select "File Cloud Gateway" mode and create a dedicated cache space
Connections	No limit	2 free and perpetual connections. Purchase license for more connections
Access Performance	Depends on network speed	High performance thanks to caching
Access in File Station	Supported	Supported
Access through SMB / NFS / AFP	Not supported	Supported
Sync with the cloud	Sync only when browsing	Sync constantly for quick access
Integration with QTS apps	Not supported	Supported 

- Online collaboration
- File data analysis

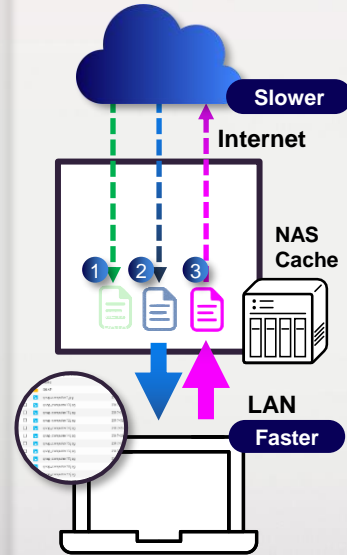

HybridMount - Cascade share the access permission to remote devices

The remote data mounted by SMB/NFS can be shared with other devices with folder permission to achieve a cascade share architecture.

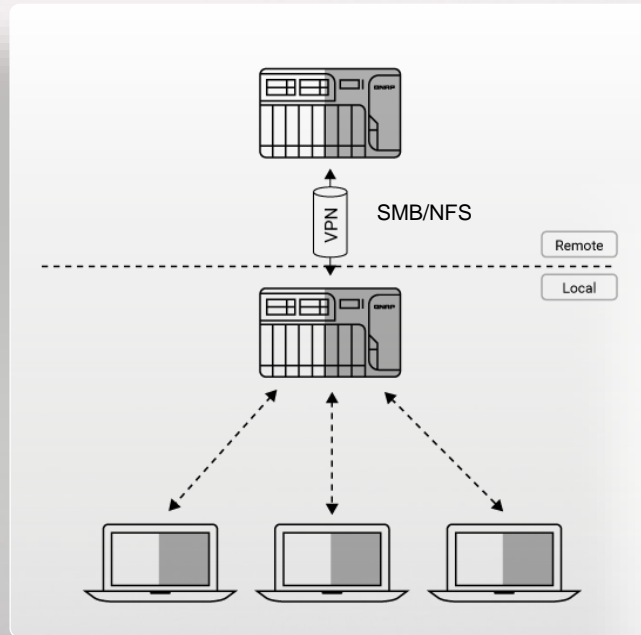
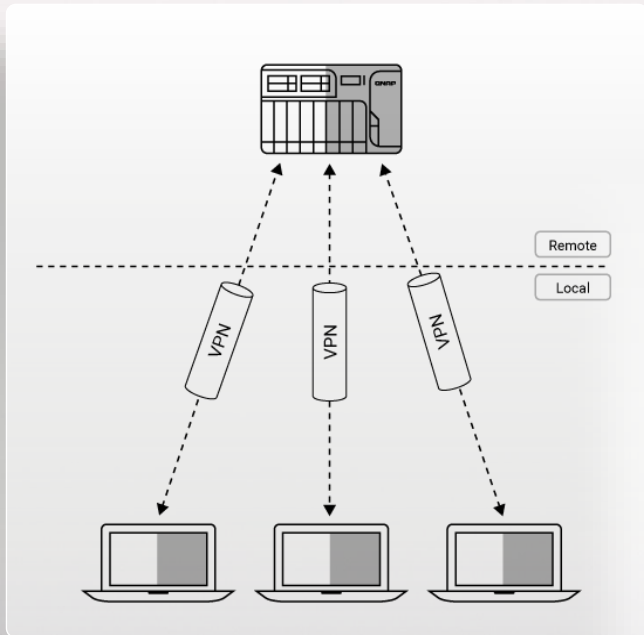

- To avoid local users accessing the remote data by VPN and to reduce the security concern and risk of VPN.
- No longer need to manage user accounts in the remote server. The local admin retains full control over assigning different permissions to local users.

Hyper Data Protector : All-in-one active backup solution for virtual machines

- Supports VMware and Microsoft Hyper-V
- Unlimited VM backups and license-free
- Active backup solution
- Restore at any time point
- Constant monitoring

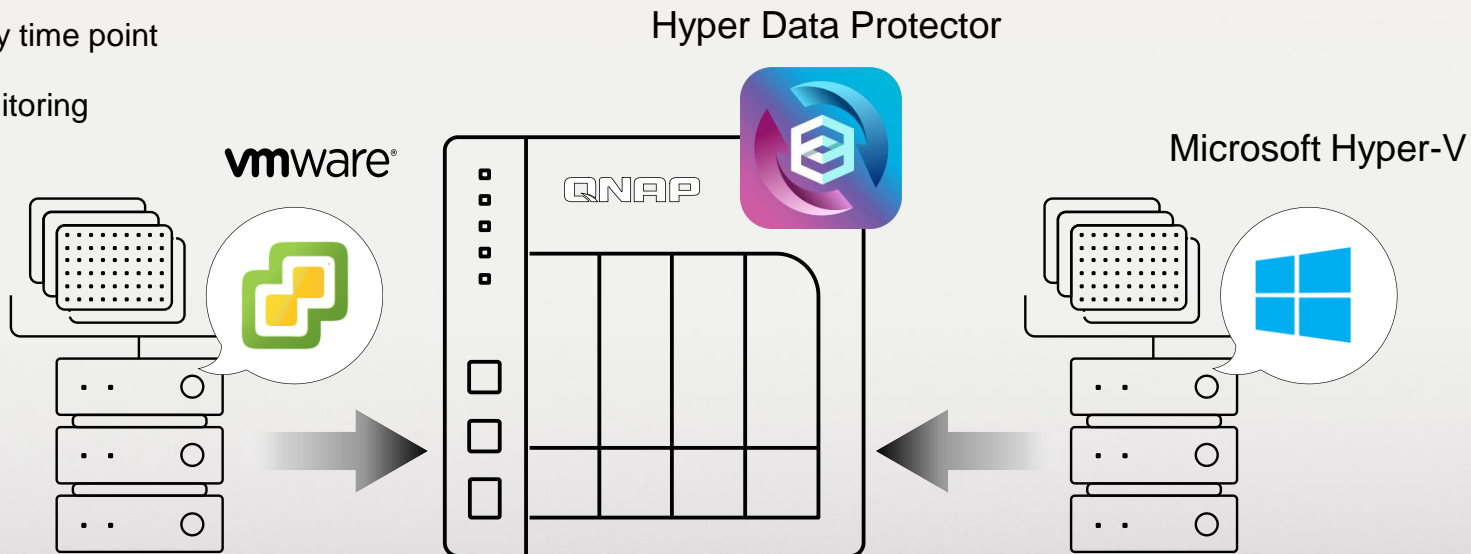

Boxafe: Comprehensive Backup Solution for Google Workspace and Microsoft 365



- Keep important data in your hands
- Move older data out of the cloud to reduce cost

Google™ Workspace



Gmail

Backup all your emails and attachments in Gmail



Google Drive

Backup all your file versions in Google Drive and supports My Drive and Shared Drive



Contacts

Backup all your contacts in Google Contacts



Calendar

Backup all your events and attachments in Google Calendar

Microsoft 365®



Outlook

Backup all your emails and attachments in Outlook



Contacts (People)

Backup all your contacts in Outlook People



Calendar

Backup all your events and attachments in Outlook Calendar



OneDrive

Backup all your files in OneDrive and support SharePoint

QmailAgent – email backup solution

Best Email Retention Solution

- Collectively manage and back up your personal and business emails.
- Easily auto back up all your emails and attachments.
- Quickly search and gain access to specific messages.
- Back up emails for disaster recovery.
- Encryption service protects backed up private emails.

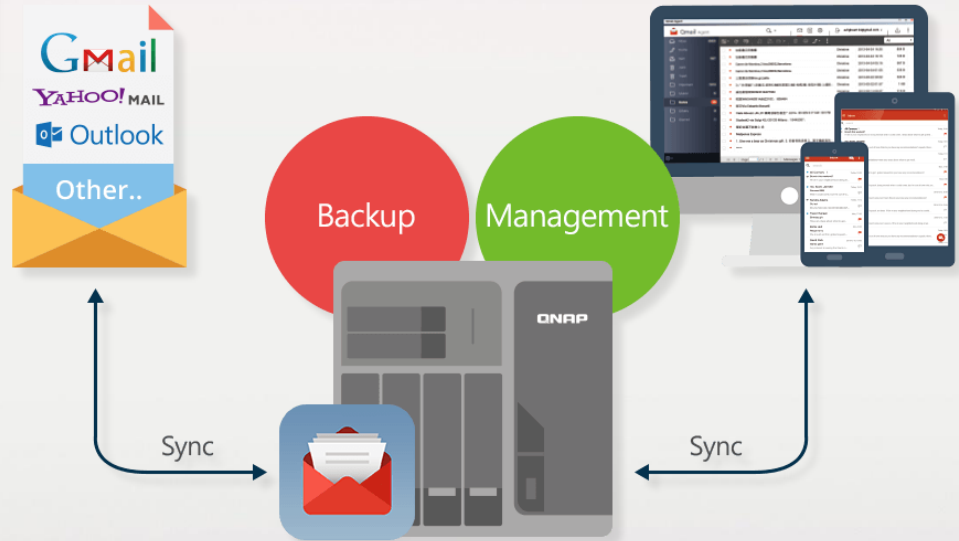

Install an NVIDIA graphics card to add HDMI output and improve VM / container performance



Support graphic cards that do not need power cables, including **NVIDIA® GTX 1650, 1050, or 1030** to add an HDMI output and boost performance of GPU-accelerated computing, virtual machines, and containers via GPU passthrough.

Note:

1. Supported video formats depend on the hardware and software specifications of the devices. Playback capability and quality may vary due to factors including the original file formats/quality, hardware and software limitations, and output devices.
2. When Virtualization Station uses graphics cards, the NAS will temporarily stop hardware transcoding acceleration for QTS (and vice versa).
3. Consult the [Compatibility List](#) for information on supported NAS and graphics cards.



**Virtualization
Station**



**Container
Station**



**Ubuntu Linux
Station**

All-in-one server to host virtual machines and containers



Virtualization Station

Supports to run the Virtual machine such as Windows, Linux[®], UNIX[®] and Android.



Container Station

QNAP's Container Station exclusively integrates LXC and Docker lightweight virtualization technologies, allowing you to download apps from the built-in Docker Hub Registry.

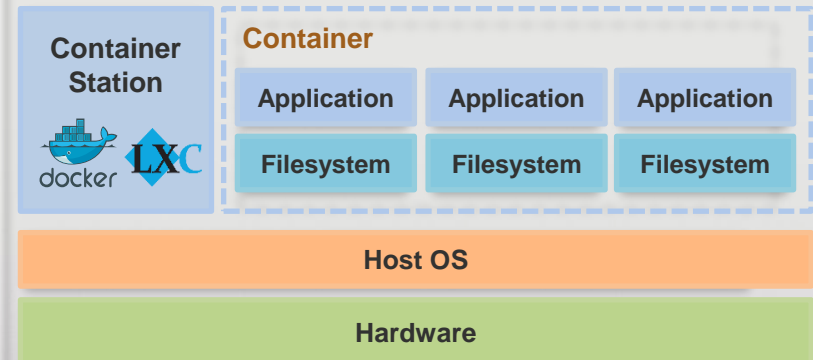

Establish and run dual systems - Ubuntu & QuTS hero



Ubuntu Linux Station

- Run QuTS hero and Ubuntu dual system, dual system application to enjoy.
- One-click installation of multiple versions Ubuntu: 16.04 / 18.04 / 20.04
- Ubuntu Software Center enjoy a variety of application downloads
- Remotely access the Ubuntu Linux desktop through a browser /
- Install a PCIe graphic card to add an HDMI output screen, and use a USB keyboard and mouse with it.

You Tube



Smart and automatic file management



Qsirch 5

A powerful, Google™-like search tool

- Search image, music, video, document, and email by keyword and filters.
- 5 advanced image search: search by face, text in image, things, color and map.
- Supports Qfiling to perform archival tasks based on your search criteria.



Qfiling 3

Automatically filing and archiving



- 2 type of task: filing task, recycling task
- 3 type of scheduling rule: one-time, scheduling, real-time
- 9 editing module: AI face blur, encryption and decryption, video transcoding and so on

Notification Center - diversity of active notification



Centralized setting

One interface to integrate all notification settings and operations



Multiple notification methods

Meet your various notification scenarios



Highly flexible rule setting

Easily filter important messages

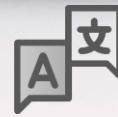

Multi-language support

Support 23 language & composed by professionals



Double insurance

Notification history and test function

Name	Model	OS Version	App Version	Action
admin (1)				
admin_Windows_Firefox	Windows	firefox 61	QTS Browser Notification 4.3.5	

Edit Rule for Event Notifications

Severity Level

Information Warning Error

Keyword Filter

All messages

Only send notifications for events that occur during a certain time period.

Time range: 00:00 - 23:59

Confirm Cancel

QuLog Center proactively analyze and monitor connections

● Proactive analysis

- List the top 5 Applications for Error/Warning Logs
- System access statistics such as connection types and logged in IP

● Quick filtering

- Categorize by APP name or date
- Customize labels/styles/flags for advanced search

● Real-time monitoring

- View the online members and their connection types

● Unified management

- Consolidate detailed local and remote NAS record files
- Set the size of the space for the record
- Send NAS log files to a standard Syslog server
- Notify specified notifications by Notification Center

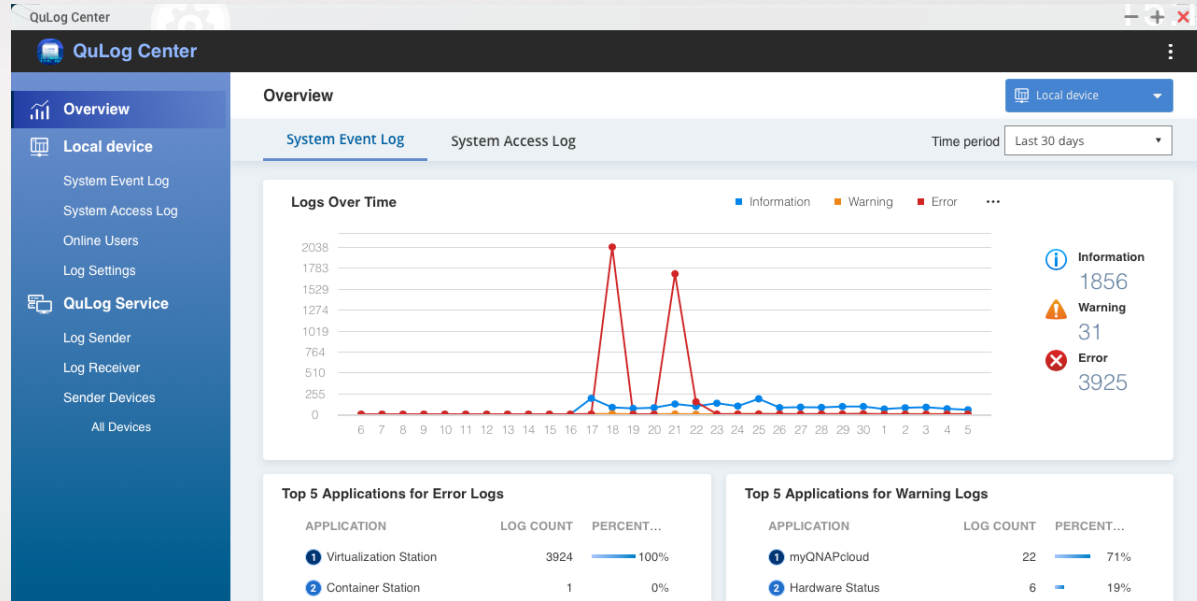

Brand new surveillance app QVR Elite

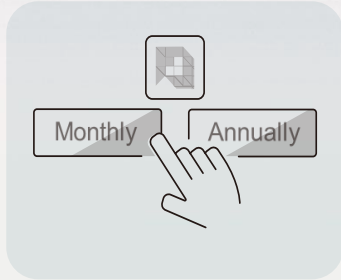

Channel License Type Unlimited

QVR Elite is subscription-based, with monthly, yearly, and 3-year subscription plans. You can build a robust surveillance system with a low-cost monthly price of US \$1.99 per channel. You can alter the subscription based on your needs to reach higher cost efficiency.

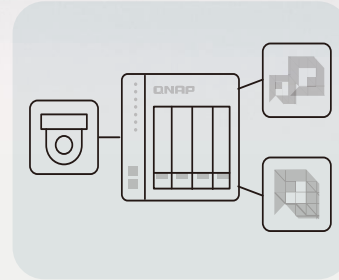

QVR Pro Client

- Supported by the QVR Pro Client same as QVR Pro's client
- Same features include Dynamic View Layout, Live and Playback at the same time, and e-map event display

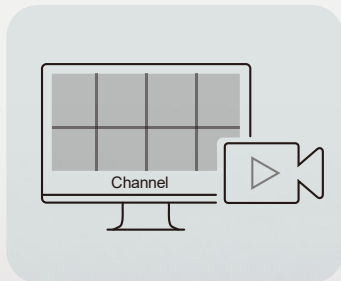

Performance Evolution

- At initial version, max recording channel is 128 channels, the next version we will increase it to 192 channels.

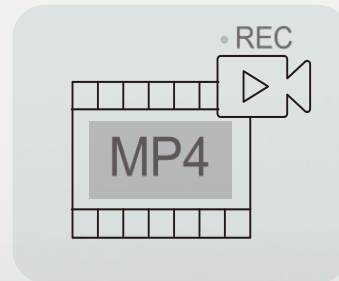

Standard MP4 file

- Supported by both QuTS hero and QTS
- Record standard MP4 format, allowing for smooth playback on all devices

High-performance multimedia streaming platform



**QuMagie AI smart photo albums
and auto classification**



Plex Server media streaming



**CAYIN MediaSign Player
HEVC (H.265) video transcoding**



**Use Cinema28 for
multi-room streaming**



With QTS / QuTS hero two systems, depending on your preference

The QTS operating system is preloaded. Businesses can switch to ZFS-based QuTS hero operating system with greater reliability based on the needs of different applications at any time.

Attention :

1. Since QTS and QuTS hero use different file systems, users must not insert the old hard disks between different operating systems to avoid data loss.
2. When using QuTS hero, we recommend to use SSD as your system drives to gain better performance.
 - a. Hot swap drives by installing 2.5" SATA SSD in two 3.5" drive bays
 - b. M.2 NVMe SSD slots on motherboard do not support hot-swapping

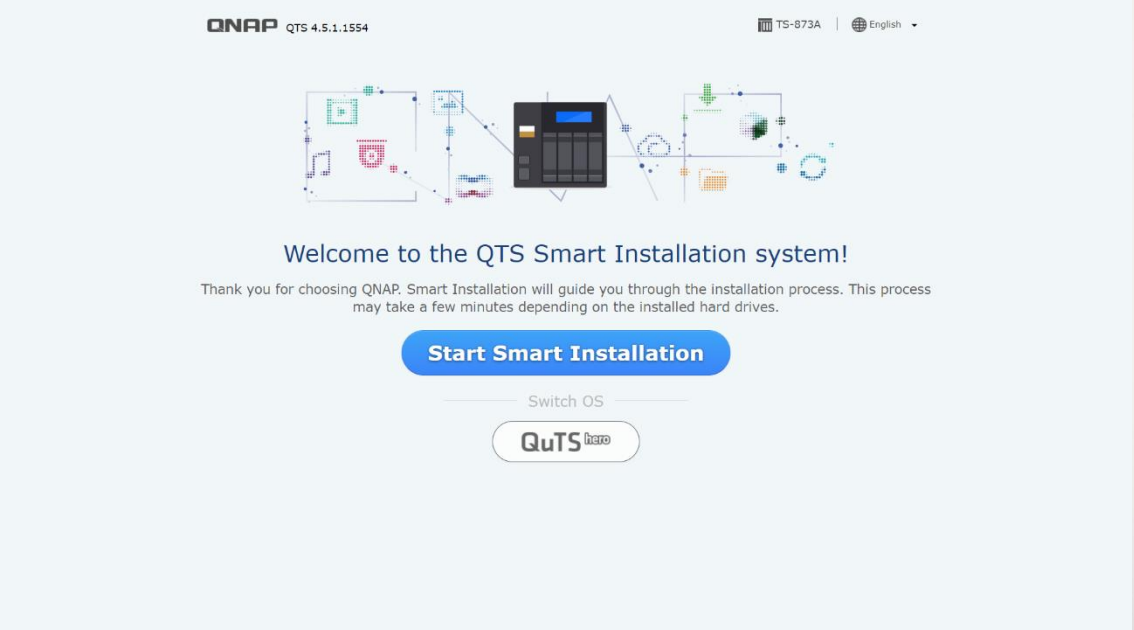

QNAP QTS 4.5.1.1554 TS-873A English

Welcome to the QTS Smart Installation system!

Thank you for choosing QNAP. Smart Installation will guide you through the installation process. This process may take a few minutes depending on the installed hard drives.

[Start Smart Installation](#)

Switch OS

[QuTS hero](#)



TS-873A



TS-673A



TS-473A

Enterprise-level OS

ZFS-based QuTS hero

Powerful data reduction – Extend the SSD endurance

It only works with inline processing before writing

ZFS file system with inline deduplication compression feature

It's the best choice to pair with the all-flash and SSD storage because it reduces the data size and pattern that need to be written to the SSD directly.

Deduplication
Min Requirement :
16GB RAM



Silent data corruption & self-healing

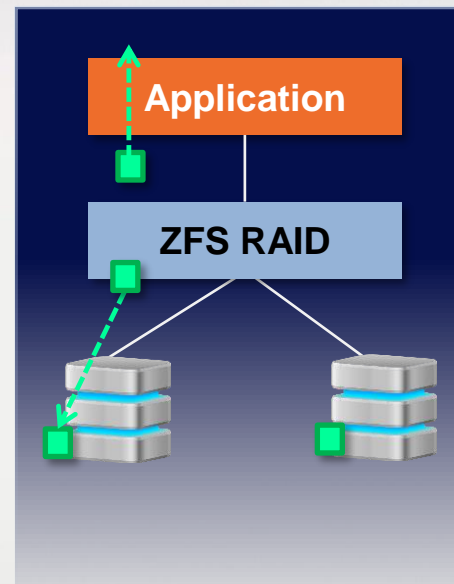
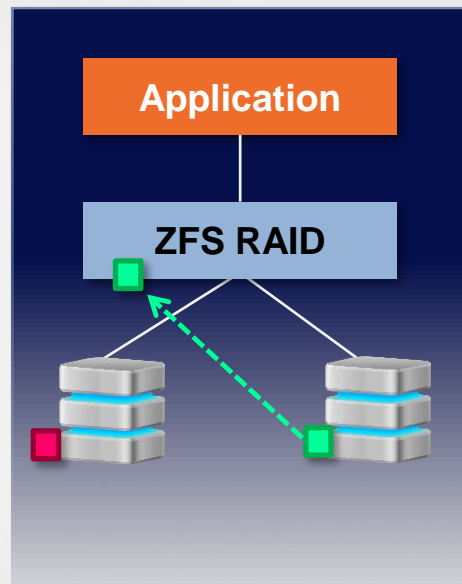
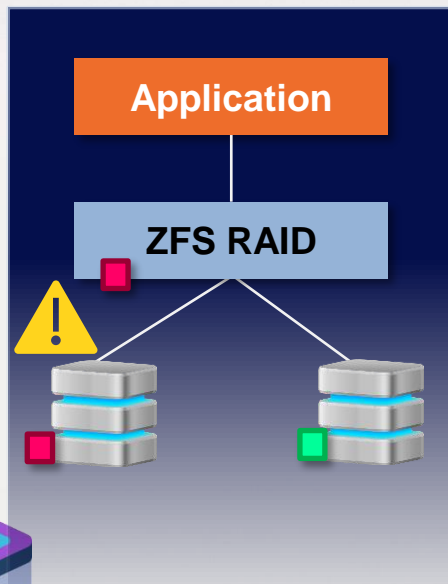

Avoid data silent corruption that occurred on running system

Three-layer backup solution

Builds the most complete data backup protection

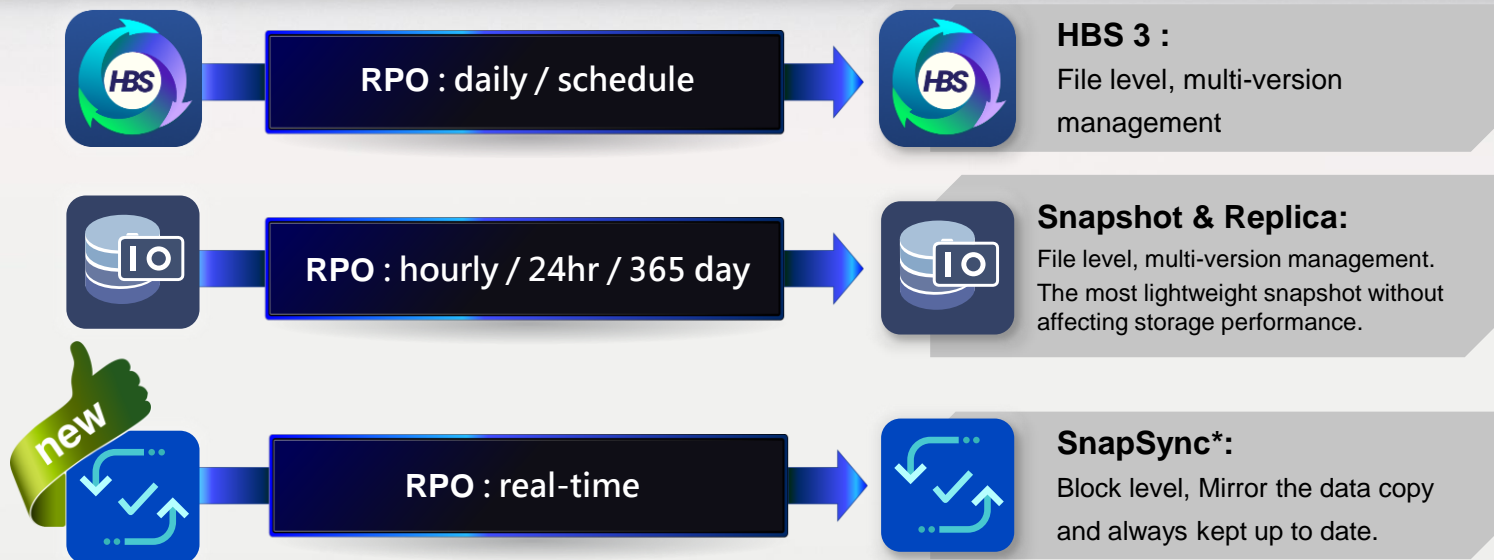

*SnapSync will be available on QuTS hero h4.5.2

Coming Soon →

SnapSync

Will be available on QuTS hero h4.5.2 (Mar 2021)

The most cost-effective backup, data protection and disaster recovery solution

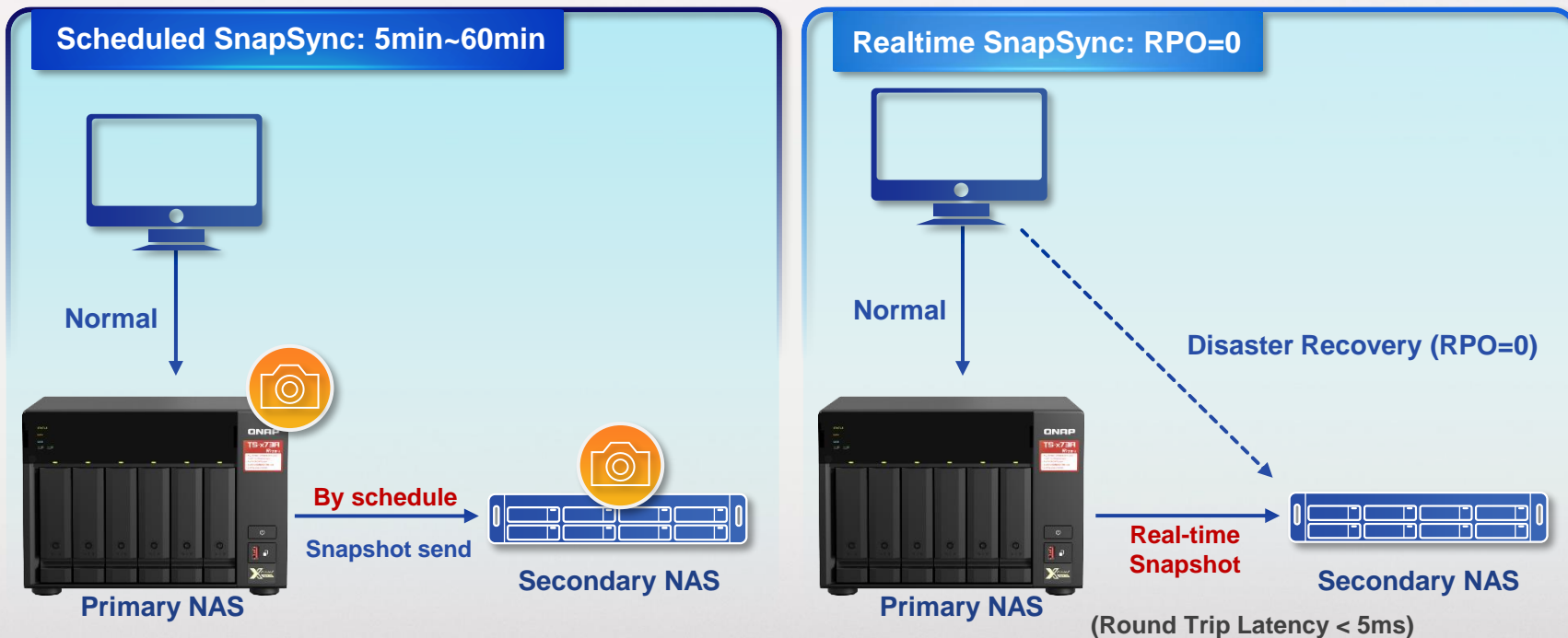



TS-873A



TS-673A



TS-473A

Multiple Storage Expansion Solutions

Storage expansion: TR-002 / TR-004 USB RAID units

- NAS with a USB port can support TR USB RAID enclosures
- Integrated USB Type-C port for plug & play, supporting USB Type-A & Type-C hosts
- NAS can connect max. 2 of TR-002/TR-004 enclosures



TR-002

USB 3.2 Gen 2 10Gbps



TR-004

USB 3.2 Gen 1 5Gbps



included

USB 3.2 Gen 1 or Gen 2 Type-C to Type-A cable



Optional

Type-C to Type-C cable

Storage expansion : TL-D800C USB JBOD units

- NAS with a USB port can support TL USB JBOD enclosures
- USB Type-C provide speed up to USB 3.2 Gen 2 10Gb/s



TL-D800C



included

USB 3.2 Gen1 or Gen 2 Type-C to Type-A cable



Optional

Type-C to Type-C cable

High-speed storage expansion with PCIe to SATA enclosures

- Install a QNAP QXP SATA HBA on NAS to access the TL expansion units via PCIe Gen3 bandwidth
- Each SFF-8088 cable provides 4 x SATA 6Gb/s = 24 Gb/s bandwidth. Connect multiple cables for up to 64 Gb/s performance

TL-D400S



TL-D800S



TL-D1600S



QXP SATA HBA and cables are included



TL-D400S



1 x QXP-400eS-A1164
PCIe to 4 x SATA 6Gb/s



1 x 1M SFF-8088 cable



TL-D800S



1 x QXP-800eS-A116
PCIe to 8 x SATA 6Gb/s



2 x 1M SFF-8088 cable



TL-D1600S

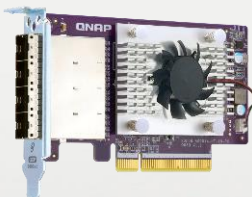

1 x QXP-1600eS
PCIe to 16 x SATA 6Gb/s



4 x 1M SFF-8088 to SFF-8644 cable

The most feature-rich and cost-effective choice



AMD Ryzen QTS / QuTS hero NAS



QNAP TS-673A / TS-873A NAS



Other 6/8-bay NAS

Two 2.5GbE LAN ports

- Fast and cost-friendly
- Support 2.5G/1G/100M Multi-Gig

Built-in 1GbE LAN port

Pre-installed high-density 8GB DDR4 memory

- Available for using more software features and connections with smooth experience
- Expand the memory up to 64GB (ECC memory supported)

4GB memory

USB 3.2 Gen2 Type-A and Gen1 Type-C ports

Support speed up to 10Gbps for backup with external SSD/HDD

USB 3.2 Gen 1 Type-A port

Two PCIe slots for more features on NAS

2 x PCIe Gen3 x4 expansion slots allow installation of 10GbE network expansion card and QM2 M.2 SSD expansion card at the same time, or other host bus adapters for more applications

One PCIe Gen3 x4 slot

Support up to sixteen 16-bay rackmount or two 16-bay desktop expansion units

Multiple QNAP SAS, SATA, USB JBOD or USB RAID expansions solutions

Max. of two 5-bay expansion units

TS-x73A Series

Legend continues, and even grows

Ryzen V1500B 4C/8T 2.2 GHz, USB 3.2 Gen2, two PCIe slots



QTS / QuTS hero





DISTRIBUIDO EN MÉXICO POR TELSMA MAYORISTA

Oriente 65A No. 2848, Asturias, Cuauhtémoc, 06850, CDMX, México

Tels.: +52 (55) 5740 2142 / 5740 0606 • ventas@telsa.com.mx • www.telsa.com.mx

Síguenos en: [Twitter.com/TelsaMayorista](https://twitter.com/TelsaMayorista) • [Facebook.com/TelsaMexico](https://facebook.com/TelsaMexico)



Contáctanos:

